

**KEY**

- Stonewall
- 1" Iron Pipe (found)—or as noted
- Granite Bound (found)—or as noted
- 3/4" Iron Rod (set)—or as noted
- Drill Hole (found)—or as noted
- Utility Pole and number
- △ Edge Road/ Drive
- Survey Control Point
- Deed Call
- Water Shut Off
- Rock

2015 OBSERVED  
MAGNETIC

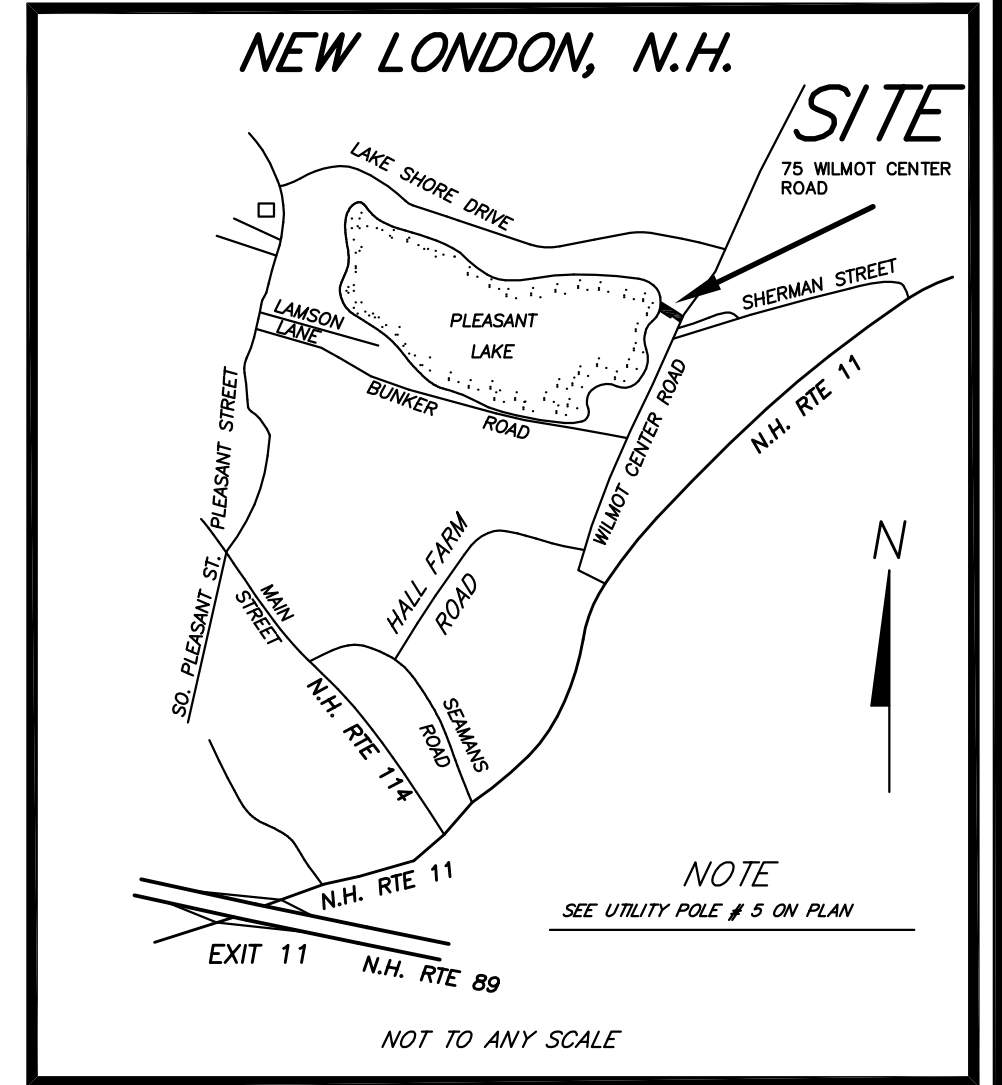

**REFERENCE PLANS**

- Merrimack County Registry of Deeds Plan # 12855, Titled "Property of Douglas N. Everett Located in New London, N.H.," Dated November 30, 1993 by this office. (See Note B)
- Merrimack County Registry of Deeds Plan # 6771, Titled "Boundary Survey, Property of Maxwell S. Cambell..." Dated October 19, 1979 by Bristol, Sweet and Associates.
- Unrecorded Plan titled "Plan of land in Elkins, N.H., Belonging to Isaac S. Craig..." Dated 1909, surveyor unknown.
- Unrecorded Plan titled "SURVEY FOR JUDITH M. OATES & WILLIAM E. MACURDA..." Dated 12-19-2007, BY BRISTOL, SWEET AND ASSOCIATES, INC.

**NOTES**

- This plan is the result of a Leica Robotic total station survey, November, 1993--October, 2020 having a control traverse relative error of closure greater than 1:5,000 (NH LAN 503.04 Category 1, Condition 2, Rural)
- Deed reference to parcels are: TM 64-1, MCR Bk. 2850, Pg. 1741 (Dec. 12, 2005); TM 78-06, MCR Bk. 3686, Pg. 1853 (July, 17, 2020).
- RIGHTS-OF-WAY AND EASEMENTS OF RECORD:
  - See M.C.R. Bk. 1121 Pg. 362 for easement reserved in the deed from Douglas Everett et al.; this includes a R.O.W. "delimited by the status of said roadway" (on the drive shown), and the use of the beach and boathouse on the Prior lot.
  - (a) RELEASE OF RIGHTS by Miriam E. Macurda in MCR Bk. 2593 Pg. 134, Release of rights of access and use of beach and boathouse.
  - Easement to Public Service Company of New Hampshire and Kearsarge Telephone Co. recorded at MCR Bk. 1421 Pg. 680.
  - Easement to Barbara Hayward recorded in MCR Bk. 1186 Pg. 515.
  - 1/4 Right-of-Way granted in a quitclaim deed from Douglas N. Everett to Barbara E. Hayward et al recorded at MCR Bk. 1121 Pg. 365.
- The fee ownership of this property extends to the natural, pre-dammed high waterline of Pleasant Lake, Elev. = ±797.9' (±6.5' below the 58' high spillway). As dam owner, the Town of New London holds a flowage easement over the land between the natural high water (797.9') and the dammed "Mean High Water Mark" (top of 58' high spillway, Elev = 804.4'). The limit of Public Waters is Elev. 803.8, Reference N.H. DES list of water bodies subject to RSA 483:2.
- All elevations are referenced to Coast and Geodetic Survey Disk Q 24 (1942) NGVD 29.
- This property is located in the R-2 Residential Zoning District. Structure setbacks are Front yard 25 Feet Rear yard 15 Feet, Side yard is Min. 20 Feet for one side and an Aggregate of 50 Feet for both sides. Minimum Lot size is 2 Acres.
- FEMA FLOOD ZONE DETERMINATION: This property is located in Zone X (Map 330230, Panel 0115). Areas determined to be outside the 0.2% annual chance floodplain.
- The property conveyed as a result of this annexation shall not be deemed or considered a separate lot of record, but shall be regarded as merged into and made an integral part of the contiguous lot of land previously owned by the grantee so that the same shall hereafter be one confirmed single lot of record.

**ANNEXATION CHART**

TAX MAP PARCEL	EXISTING ACRES	ANNEXATION PARCEL	FINAL ACRES AFTER ANNEXATION	ROAD FRONTAGE AFTER ANNEXATION	WATER FRONTAGE AFTER AGREEMENT AND ANNEXATION
64-1	0.37 AC.	Parcel A 0.97 AC.	TAX MAP 64-1	WILMOT CENTER ROAD	±193.2'
			1.34 Acres	50.03'	
78-6	± 1.70 AC.		TAX MAP 78-6	WILMOT CENTER ROAD	0
			0.73 Acres	173.33'	

PRESENTATION AFTER ANNEXATION  
ANNEXATION PLAN

TAX MAP 64, PARCEL 1, 73 WILMOT CENTER ROAD  
PROPERTY OF  
**WILLIAM HAYWARD MITCHELL**  
**DEBRA B. MITCHELL**  
**JAMES HAYWARD MITCHELL**  
**MARY ANN HAYWARD REV. TRUST**  
PO BOX 57, ELKINS, NH 03233

AND TAX MAP 78, PARCEL 6, 77 WILMOT CENTER ROAD  
PROPERTY OF  
**JAMES HAYWARD MITCHELL**  
**WILLIAM HAYWARD MITCHELL**  
**MARY ANN HAYWARD REV. TRUST**  
1 LAKEVIEW DR, HANOVER, NH 03748

LOCATED IN  
**NEW LONDON, NEW HAMPSHIRE**

Scale in Feet =

1" = 40'

November 2, 2020

PREPARED BY PIERRE J. BEDARD, and ASSOCIATES, P.C., P.O. BOX 238, WILMOT, N.H. 03287.  
LAND SURVEYING, SEWAGE DISPOSAL DESIGN, and NATURAL RESOURCE CONSULTANTS.

