

KEY

- Stonewall
- 1" Iron Pipe (found)—or as noted
- Granite Bound (found)—or as noted
- 3/4" Iron Rod (set)—or as noted
- Drill Hole (found)—or as noted
- Utility Pole and number
- △ Edge Road/ Drive
- Survey Control Point
- Deed Call
- Water Shut Off
- Rock

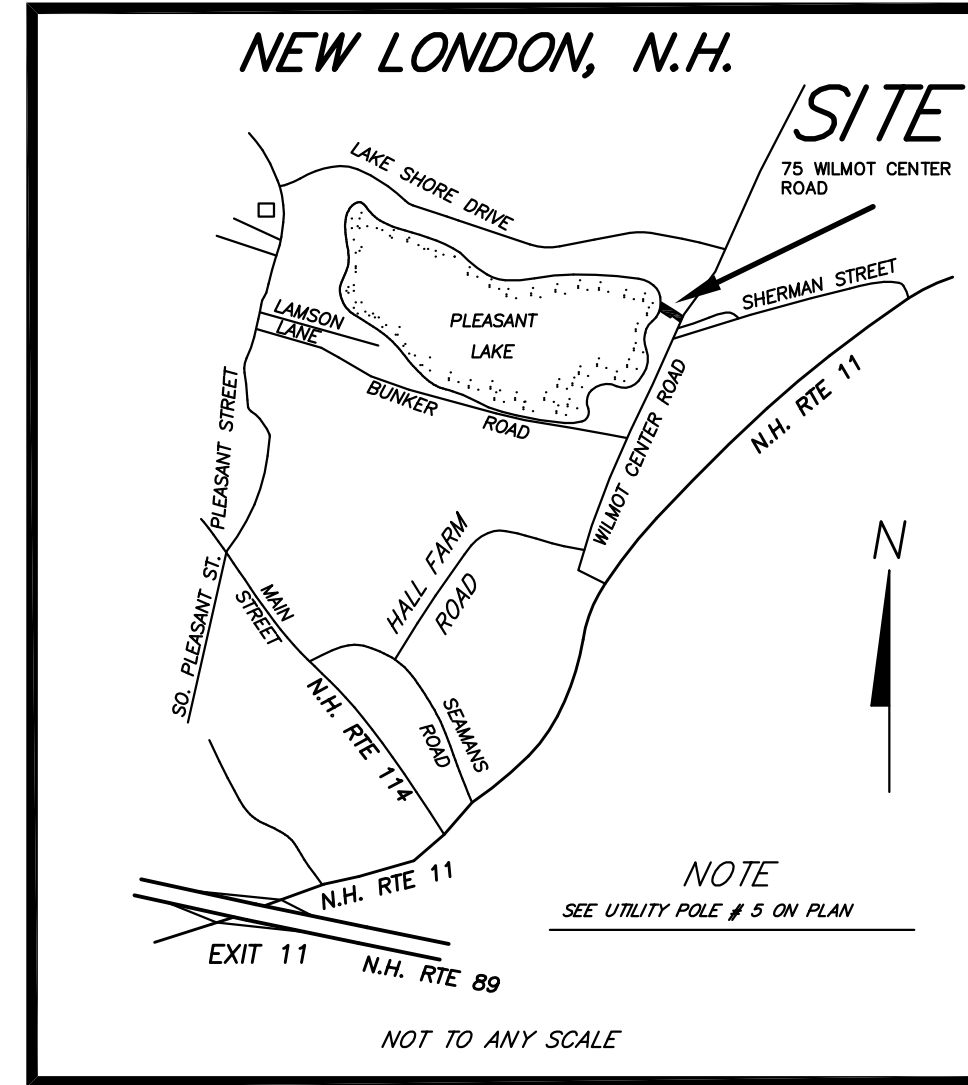

LOCATION MAP

2015 OBSERVED
MAGNETIC

PRESENTATION EXISTING
PROPOSED ANNEXATION PLAN

TAX MAP 64, PARCEL 1, 73 WILMOT CENTER ROAD
PROPERTY OF
WILLIAM HAYWARD MITCHELL
DEBRA B. MITCHELL
JAMES HAYWARD MITCHELL
MARY ANN HAYWARD REV. TRUST
PO BOX 57, ELKINS, NH 03233

AND TAX MAP 78, PARCEL 6, 77 WILMOT CENTER ROAD
PROPERTY OF
JAMES HAYWARD MITCHELL
WILLIAM HAYWARD MITCHELL
MARY ANN HAYWARD REV. TRUST
1 LAKEVIEW DR. HANOVER, NH 03748

LOCATED IN
NEW LONDON, NEW HAMPSHIRE

Scale in Feet =

1" = 40'

November 2, 2020

PREPARED BY PIERRE J. BEDARD, and ASSOCIATES, P.C., P.O. BOX 238, WILMOT, N.H. 03287.
LAND SURVEYING, SEWAGE DISPOSAL DESIGN, and NATURAL RESOURCE CONSULTANTS.

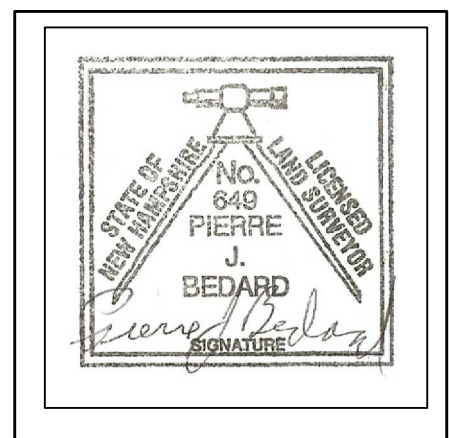

REFERENCE PLANS

1. Merrimack County Registry of Deeds Plan # 12855, Titled "Property of Douglas N. Everett Located in New London, N.H.," Dated November 30, 1993 by this office. (See Note B)
2. Merrimack County Registry of Deeds Plan # 6771, Titled "Boundary Survey, Property of Maxwell S. Cambell..." Dated October 19, 1979 by Bristol, Sweet and Associates.
3. Unrecorded Plan titled "Plan of land in Elkins, N.H., Belonging to Isaac S. Craig..." Dated 1909, surveyor unknown.
4. Unrecorded Plan titled "SURVEY FOR JUDITH M. OATES & WILLIAM E. MACURDA..." Dated 12-19-2007, BY BRISTOL, SWEET and ASSOCIATES, INC.

NOTES

B. The property conveyed as a result of this annexation shall not be deemed or considered a separate lot of record, but shall be regarded as merged into and made an integral part of the contiguous lot of land previously owned by the grantees so that the same shall hereafter be one confirmed single lot of record.

ANNEXATION CHART

TAX MAP PARCEL	EXISTING ACRES	ANNEXATION PARCEL	FINAL ACRES AFTER ANNEXATION	ROAD FRONTAGE AFTER ANNEXATION	WATER FRONTAGE AFTER AGREEMENT AND ANNEXATION
64-1	0.37 AC.	Parcel A 0.97 AC.	TAX MAP 64-1	WILMOT CENTER ROAD	±193.2'
			1.34 Acres	50.03'	
78-6	± 1.70 AC.		TAX MAP 78-6	WILMOT CENTER ROAD	0
			0.73 Acres	173.33'	