

Report of Tree Inspection

Subject Tree(s): One 26" white ash (*Fraxinus americana*), one 24" white ash and one 26" red maple (*Acer rubrum*) at 221 Lamson Lane New London, NH.

Assignment:

Tree Risk Assessment

Observations:

The subject ash trees are dead, likely due to emerald ash borer infestation. The subject red maple is alive; however it has a significant lean towards the house and a trunk cavity near the base.

Discussion:

All three trees are within striking distance of house or dock structures and would cause significant damage or possible injury in the likely event of failure.

The red maple has a sweeping 10 degree lean towards the house and a live crown ratio of approximately 50%. The combination of this lean and trunk defect increases the likelihood of failure and impacts with significant or severe consequences. This tree is now further exposed to north and northeast winds from across Pleasant Lake due to the loss of the adjacent ash tree, creating an additional risk factor.

Conclusions:

The three subject trees should be removed as soon as is practicable.

Limiting Conditions: There is no assumption or agreement requiring this consultant to give testimony in court without a separate contract agreement. This report relies on a visual inspection only. The consultant cannot be responsible for unseen and unknown conditions.

Certification:

I hereby certify that I am a member in good standing of the International Society of Arboriculture (ISA), and the American Society of Consulting Arborists (ASCA). I also certify that my assessment is based on current tree risk concepts and up-to-date training through the Tree Risk Assessment Qualification (TRAQ) program administered by the ISA.

Brian Beaty
Brian Beaty RCA, BCMA August 8, 2025



Figure 1. Subject Trees

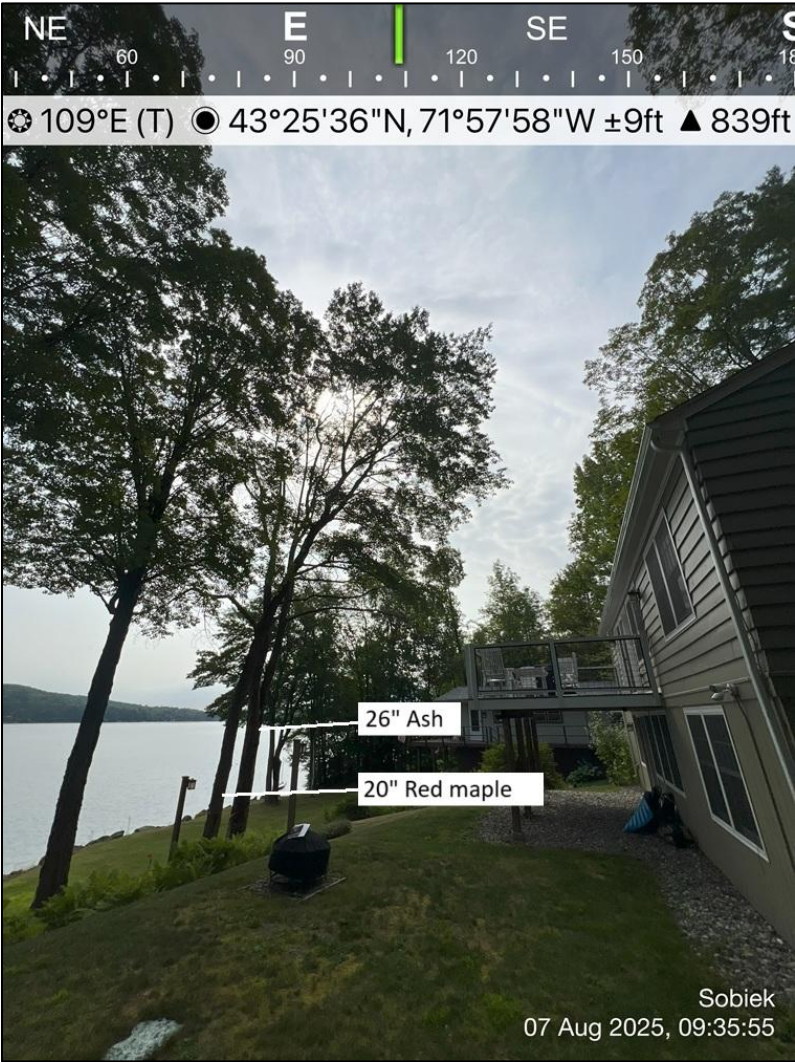

Figure 2. Ash and Maple



Figure 3. Maple Trunk North Side



Figure 4. Maple Trunk South Side



Figure 5. **Dead Ash #1**



Figure 6. Dead Ash #2



Figure 7. Maple Lean Toward House

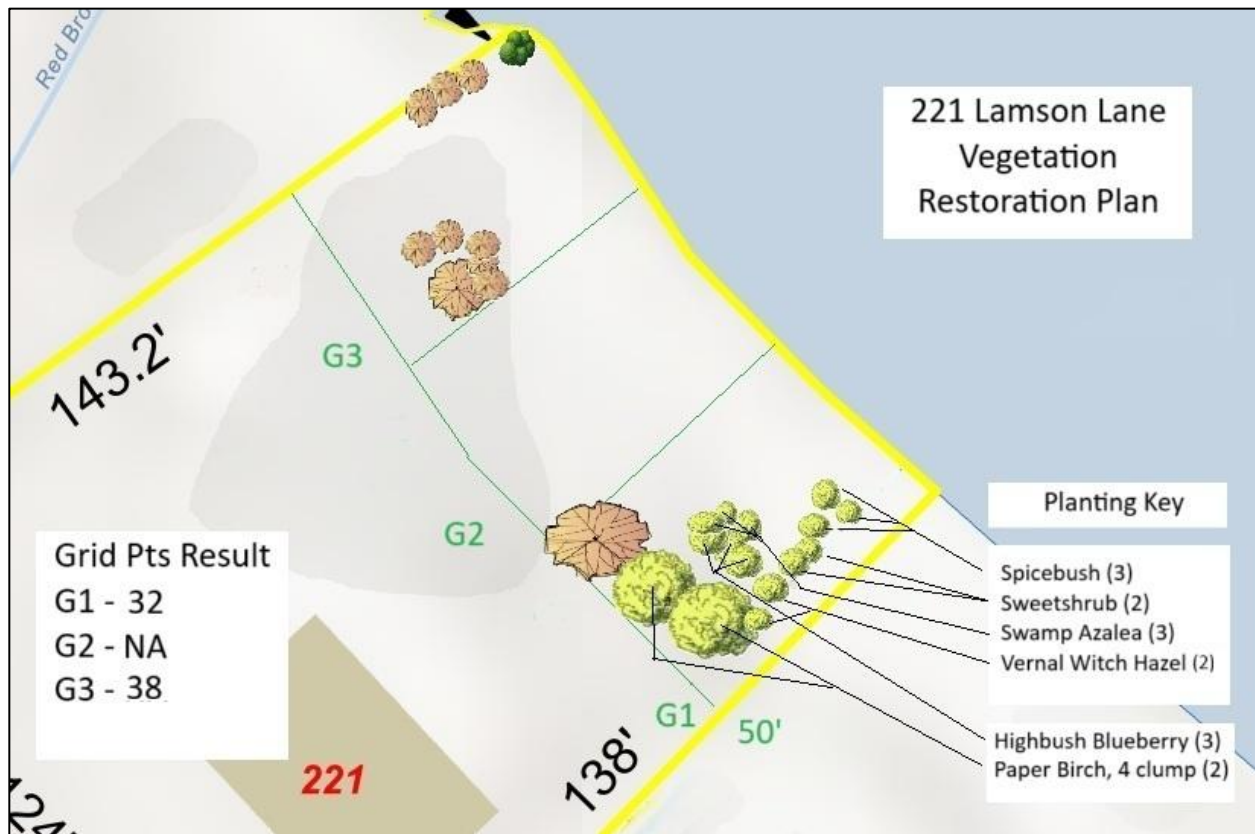

Figure 8. Vegetation Restoration Plan