

- KEY**
- Boundary Stonewall
 - Interior/Exterior Stonewall
 - Setback Per Zoning
 - 1" Iron Pipe (found) - or as noted
 - Iron Rod in Drillhole (set)
 - Edge Paved Road/ Drive
 - Woods Road/Trail
 - Culvert
 - Utility Pole w/ Overhead Lines
 - Tree Line/ Edge Field

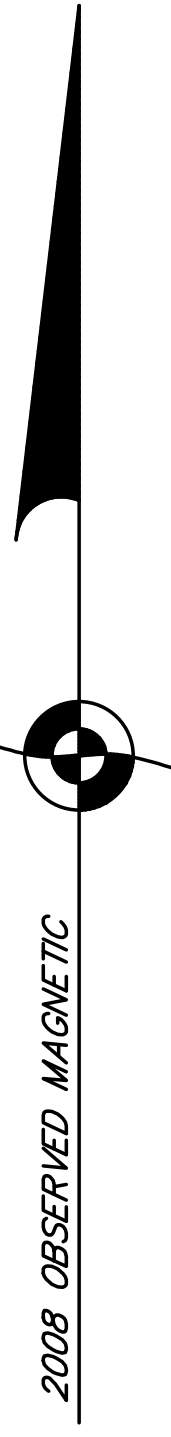

2008 OBSERVED MAGNETIC

Tax Map 58 Lot 25
DAVID HALE TRUST
4169 Keller Court
Cincinnati OH 45245
MCR 2210-04, 2000

Tax Map 58 Lot 24
PAMELA CHILD
PO Box 969
New London NH 03257
MCR 3458-649, 2014

Tax Map 58 Lot 23
Town of New London
375 Main Street
New London, NH 03257
MCR 1201-242, 1973
MCR 1269-710, 1976

Tax Map 71 Lot 14
CHARLES GAEDE III
227 Pine Hill Road
New London NH 03257
MCR 3680-694, 2020

Tax Map 71 Lot 13
MARIA and JEFFREY DAILEY
215 Pine Hill Road
New London NH 03257
MCR 3596-925, 2018

Tax Map 71 Lot 12
DAVIDSON FAMILY TRUST
PO Box 112
New London NH 03257
MCR 2244-1815, 2001

Tax Map 71 Lot 11
GLENN and ELLEN HUDSON
169 Pine Hill Road
New London NH 03257
MCR 3596-925, 2018

(LOT 3)
Tax Map 71 Lot 10
ANDREW and JANET BULLOCK
139 Pine Hill Road
New London NH 03257
MCR 3610-1862, 2018

Tax Map 71 Lot 4
FRANK and KATHY DEL GIUDICE
100 Carter Road
New London NH 03257
MCR 2227-995, 2000

Tax Map 71 Lot 5
CHRISTOPHER and SARAH KELLY
86 Carter Road
New London NH 03257
MCR 3635-2505, 2019

Tax Map 71 Lot 6
KIMBERLY ILLG
80 Carter Road
New London NH 03257
MCR 3593-1427, 2018

Tax Map 70 Lot 37
MICHAEL and MARIA STANCOMBE
112 Gay Farm Road
New London NH 03257
MCR 3654-1908, 2019

Tax Map 70 Lot 37
MICHAEL and MARIA STANCOMBE

**TAX MAP 70 LOT 72
ROBAR FAMILY TRUST
±4.1 ACRES
(AFTER ANNEXION)
(±29.8 ACRES BEFORE ANNEXION)**

Tax Map 70 Lot 38
NANCY SMITH
PO Box 2558
Vail CO 81658
MCR 3004-1364, 2007

Tax Map 70 Lot 39
MICHAEL and REBECCA FRIEDMAN
80 Gay Farm Road
New London NH 03257
MCR 3510-790, 2016

Tax Map 70 Lot 43
DENNIS VARLEY and ANTONIA ENCIZO
164 Broadway
Bethpage, NY 11714
MCR 1586-380, 1986

Tax Map 70 Lot 41
PATTON LIVING TRUST
13 College Hill
Hanover NH 03755
MCR 2691-1810, 2004

**PARCEL A - 25.74 ACRES
TO BE ANNEXED FROM TM 70-42 (ROBAR)
TO TM 71 LOT 3 (STEVERSON)**

**TAX MAP 71 LOT 3
PATRICIA and GREGORY STEVERSON
31.16 ACRES
(AFTER ANNEXION)
(5.42 ACRES BEFORE ANNEXION)**

NOTES

1. Deed References:
A. MCR Book 2964 Page 1218, Patricia Steverson to the Patricia Steverson Trust, February 1, 2007.
B. MCR Book 2964 Page 1220, Gregory Steverson to the Gregory Steverson Trust, February 1, 2007.
C. MCR Book 2402 Page 201 (Tr-1), Don and Elaine Robar to the Robar Family Trust, August 20, 2002.
2. This plan is the result of a Nikon total station and GMax35 GPS survey, October 2021, meeting the NH Standards for a rural property survey. This survey included all of Parcel A being conveyed and TM 71-03 (Steverson). The Robar house lot and lane way is shown as presented on Reference Plan 2.
3. All information is referenced to NH State Plane datum with bearing rotated to Magnetic North.
4. This property is located in the ARR zoning district; the required building setback are 25' from the sidelines, and 50' from the edge of Carter Road.
5. The purpose of this plan is to show the annexation of Parcel A (25.74 acres) from TM 70-42 (Robar) to Tax Map 71-03 (Steverson).
6. The property conveyed as a result of this annexation shall not be deemed a separate lot of record, but shall be regarded as merged into and made an integral part of the contiguous lot of land previously owned by the grantee so that the same shall hereafter be one combined single lot of record.
7. The right of way for the driveway cited in MCR 1198-407 (Stoney to Robar) serves the Steverson property and this drive will run through the Steverson property once the annexation is complete.

PLAN OF ANNEXATION

PROPERTY TO BE CONVEYED FROM
TAX MAP 70 LOT 42 - 51 CARTER ROAD
ROBAR FAMILY TRUST OF 2002
51 CARTER ROAD, NEW LONDON, NH 03257

TO TAX MAP 71 LOT 3 - 124 CARTER ROAD
GREGORY D. STEVERSON 2006 REVOCABLE TRUST
PATRICIA L. STEVERSON 2006 REVOCABLE TRUST
PO BOX 1406, NEW LONDON, NH 03257

LOCATED IN
NEW LONDON, N.H.

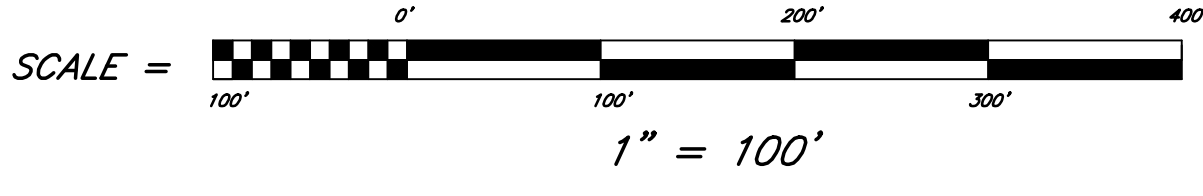

NOVEMBER 16, 2021

PENNYROYAL HILL LAND SURVEYING & FORESTRY LLC
CLAYTON E. PLATT LIC. SURVEYOR NO. 833
414 Pine Hill Road Croydon, NH 03773 (603) 863-0981

REFERENCE PLANS

1. MCR Plan 2203 - "Stanley Farm Acres, Building Lots...", by Robert Bristol, November, 1967.
2. MCR Plan 16999 - "Annexation Plan, Property Of Donald and Elaine Robar...", by Pierre Bedard, July 13, 2004.
3. MCR Plan 1739 - "Gay Farm Acres, New London, NH, Owned by A.T & Hazel Kirk, James E. Bewley...", by Chester Melendy, 1960.
4. MCR Plan 3762 - "Pine Hill Acres, Property of Oscar T. Halley and John T. Halley...", by Robert Bristol, September 6, 1974.
5. MCR Plan 3360 - "New London Conservation Commission, Owner: Lois Philbrick Childs...", by Robert Bristol, February 14, 1973.

APPROVED BY THE NEW LONDON, N.H. PLANNING BOARD

Date _____

(NAME) _____

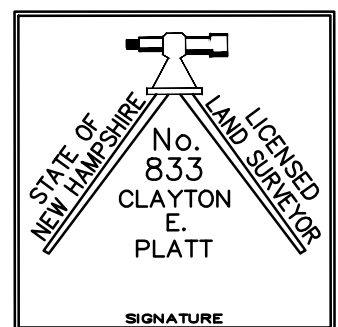

REVISIONS

The Subdivision Regulations of the Town of New London are a part of this plan and approval of this plan is contingent on the completion of all requirements of said Subdivision Regulations excepting only any variances or modifications made in writing by the Board and attached hereto.